

State Disposal System

MN0071501

Permittee: YMCA of the Greater Twin Cities
Facility name: YMCA of the Greater Twin Cities Wastewater Treatment Facility
Township: New Market **County:** Scott
Issuance date: TBD
Expiration date: TBD

The state of Minnesota, on behalf of its citizens through the Minnesota Pollution Control Agency (MPCA), authorizes the Permittee to operate a disposal system at the facility named above, in accordance with the requirements of this permit.

The goal of this permit is to reduce pollutant levels in point source discharges and protect water quality in accordance with the U.S. Clean Water Act, Minnesota statutes and rules, and federal laws and regulations.

This permit is effective on the issuance date identified above. This permit expires at midnight on the expiration date identified above.

Signature:

This document has been electronically signed.

Randy Thorson, P.E.
Supervisor
Metro Regional and Infrastructure Financing Unit
Municipal Division

for the Minnesota Pollution Control Agency

Submit eDMRs

Submit via the MPCA e-Services at
https://rsp.pca.state.mn.us/TEMPO_RSP/Orchestrate.do?initiate=true

Submit WQ reports to:

Electronically: wq.submittals.mPCA@state.mn.us
Include *Water quality submittals form*:
<https://www.pca.state.mn.us/sites/default/files/wq-wwprm7-71.docx>

Or, by mail:

Attention: WQ Submittals Center
Minnesota Pollution Control Agency
520 Lafayette Road North
St. Paul, MN 55155-4194

*Whole Effluent Testing (WET) and Pretreatment Annual Reports
must be mailed to the WQ Submittals Center*

Questions on this permit?

For eDMR and other permit reporting issues, contact:
Erin Carter (erin.carter@state.mn.us) 651-757-2812

For specific permit requirements, please refer to:

Cara Omana (cara.omana@state.mn.us) 651-757-2891

Wastewater Permit Program general questions, contact:

MPCA, 651-282-6143 or 1-800-657-3938.

Table of Contents

	Page
1. Permitted facility description.....	3
2. Location map of permitted facility.....	4
3. Flow diagram.....	6
4. Summary of stations and station locations.....	7
5. Permit requirements.....	8
6. Submittal action summary	26
7. Limits and monitoring.....	29

DRAFT

1. Permitted facility description

The YMCA of the Greater Twin Cities facility (Facility) is located in New Market Township, Scott County, Minnesota 55054.

The site consists of two existing subsurface sewage treatment system (SSTS) and two proposed SSTS as described below. The total design average wet weather (AWW) flow of all systems is 10,400 gallons per day (gpd). All systems are Class D.

Existing Facilities

The Facility currently discharges from two existing homes on site.

The two-bedroom cabin system was installed in 2000 and is designed to treat an AWW flow of up to 300 gpd. The treatment system consists of a 1,250-gallon septic tank, a 1,000-gallon pump tank, and a 45 x 55 ft-mound system.

The five-bedroom home system was installed in 1980 and is designed to treat an AWW flow of up to 800 gpd. The treatment system consists of 1,550-gallon septic tank, a 100-gallon pump tank, and drainfield trenches.

Proposed Facilities

The permittee proposes to construct two additional systems.

The horse barn system has a design AWW flow of 800 gpd. The treatment system will consist of two 1,200-gallon septic tanks in series, one 2,000-gallon pump tank, and a 61 x 128 ft mound. An area has been reserved for a replacement mound if needed.

The welcome center/pool area system has a design AWW flow of 8,500 gpd. The treatment system will consist of one 5,000-gallon septic tank, followed by four 5,000-gallon tanks in two parallel sets of two tanks, a 6,000-gallon pump tank, and a 67.4 x 476 ft-mound. Provisions will be included to add an 8,000-gallon equalization tank depending on usage and flow. An area has been reserved for a replacement mound if needed.

2. Location map of permitted facility

The Horse Barn System

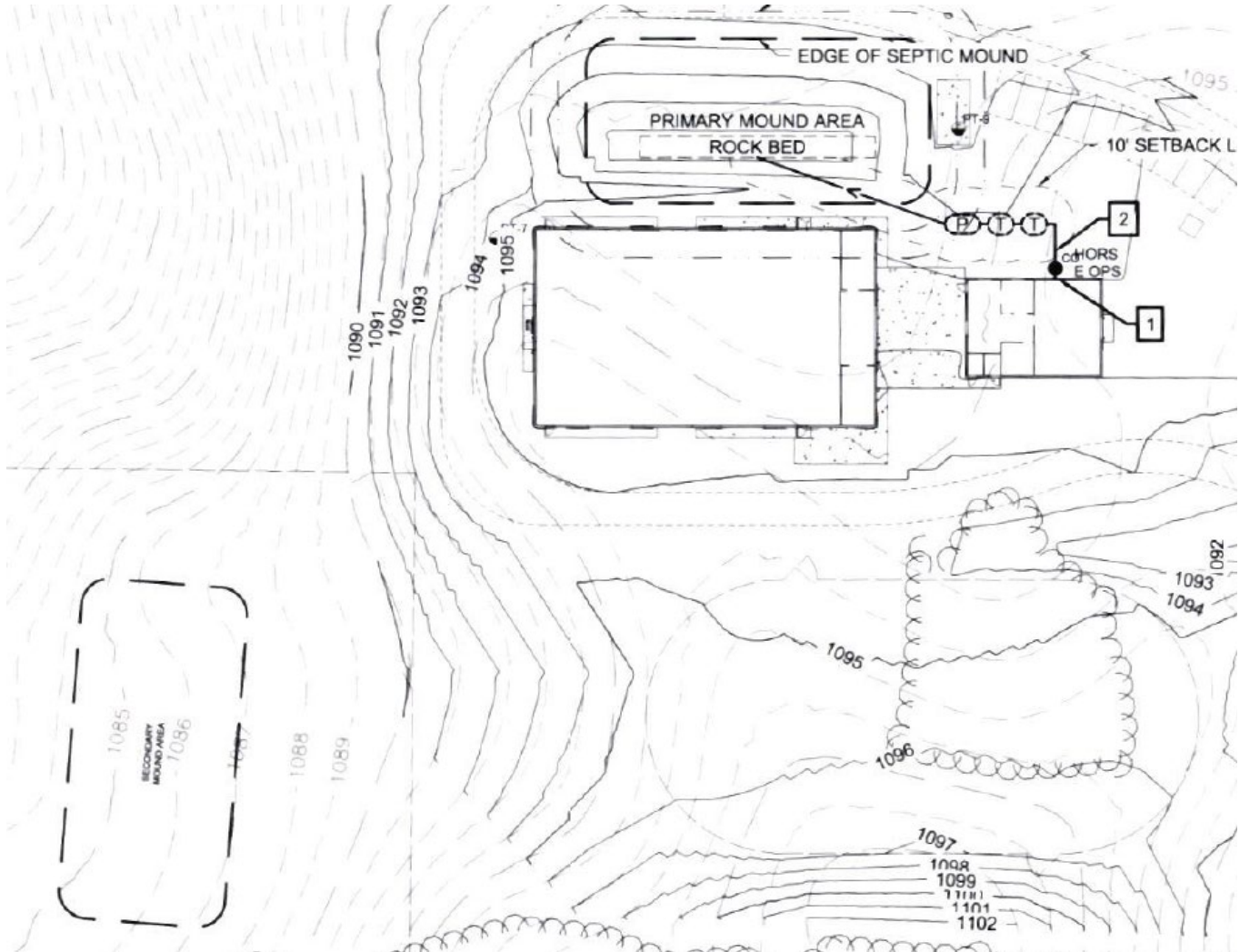

The Pool System

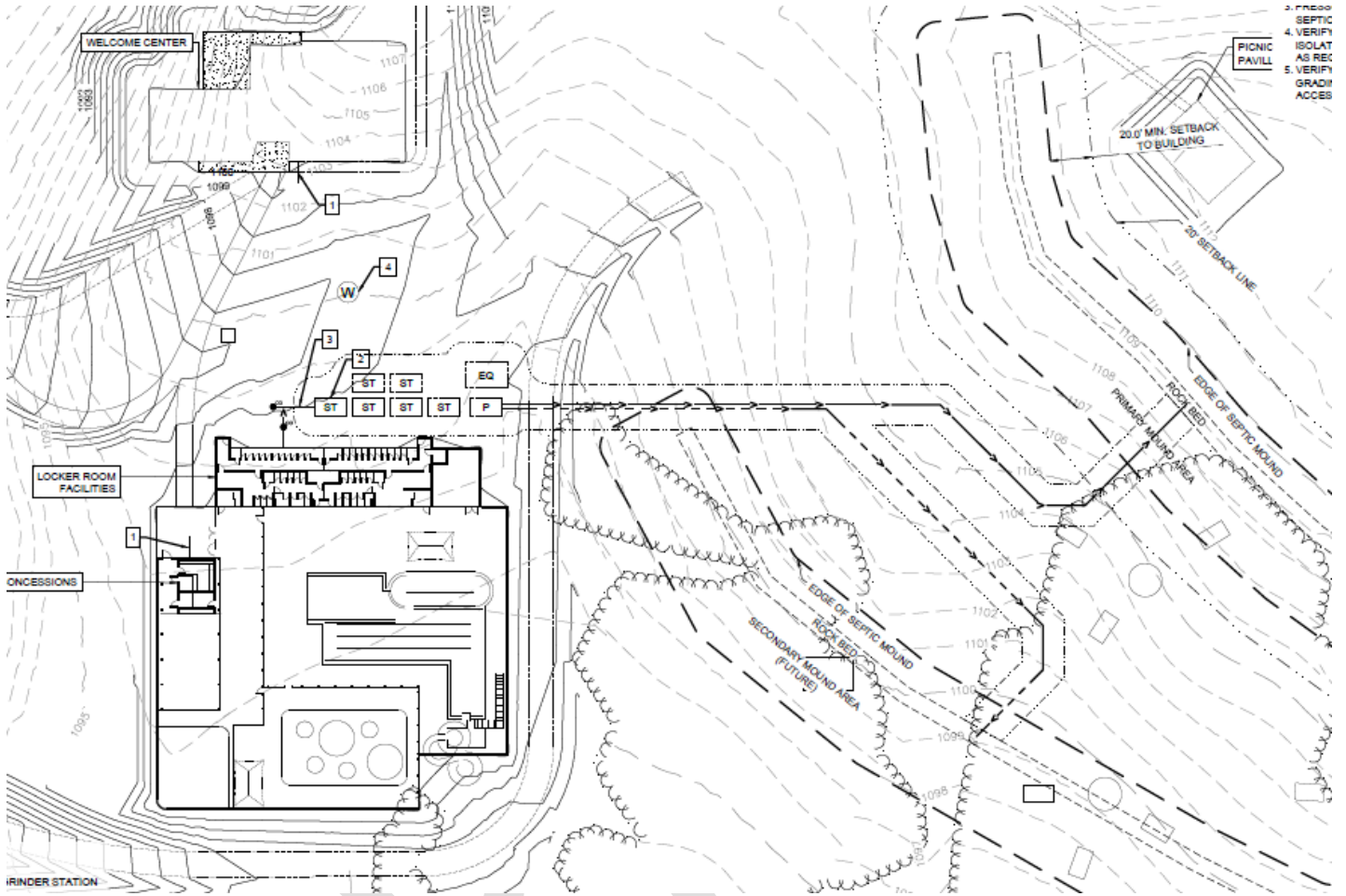

DR

3. Flow diagram

Horse Barn System Layout



Pool Area System Layout

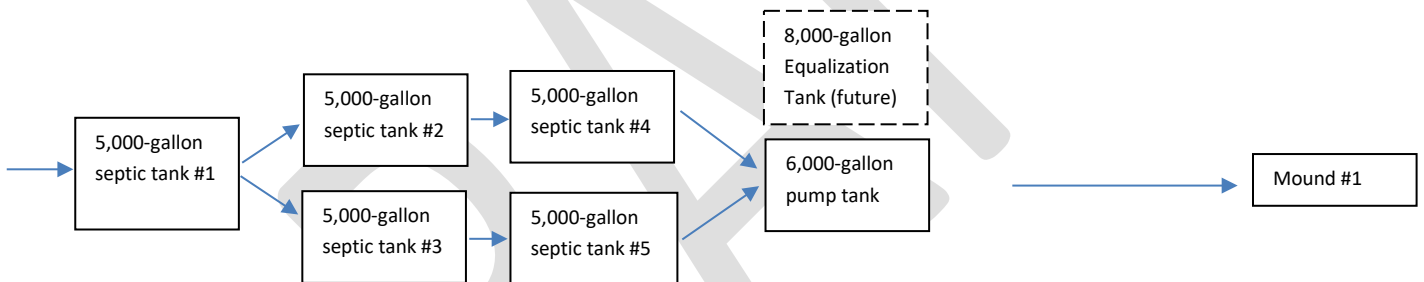

4. Summary of stations and station locations

Station	Type of station	Local name	PLS location
GW 001	Piezometer, Other	Piezometer - 5 Bedroom House	T113N, R21W, S09, NE Quarter of the NW Quarter
WS 001	Influent Waste	Influent Waste - 2 Bedroom House	T113N, R21W, S09, NW Quarter of the NE Quarter
WS 002	Internal Waste Stream	Septic Tank - 2 Bedroom House	T113N, R21W, S09, NW Quarter of the NE Quarter
WS 003	Influent Waste	Influent Waste - 5 Bedroom House	T113N, R21W, S09, NE Quarter of the NW Quarter
WS 004	Internal Waste Stream	Septic Tank - 5 Bedroom House	T113N, R21W, S09, NE Quarter of the NW Quarter
WS 005	Influent Waste	Influent Waste - Horse Barn	T113N, R21W, S09, SW Quarter of the NW Quarter
WS 006	Internal Waste Stream	Septic Tank - Horse Barn	T113N, R21W, S09, SW Quarter of the NW Quarter
WS 007	Influent Waste	Influent Waste - Pool System	T113N, R21W, S09, NE Quarter of the SW Quarter
WS 008	Internal Waste Stream	Septic Tank #6- Pool System	T113N, R21W, S09, NE Quarter of the SW Quarter

5. Permit requirements

GW 001	Piezometer, Other	
		Groundwater Well: Large Subsurface Sewage Treatment System Piezometer Monitoring Requirements
	5.1.1	The Permittee shall submit a monthly DMR : Due by 21 days after the end of each calendar month following permit issuance. [Minn. R. 7001.0150, Subp. 2(B)], Phases: Phase 1, Phase 2, Phase 3
	5.1.2	Sampling Location. [Minn. R. 7001.0150, Subp. 2(B)]
	5.1.3	Samples for Station GW 001 shall be taken at the piezometer installed at the drainfield of the 5 bedroom house. [Minn. R. 7001.0150, Subp. 2(B)]
	5.1.4	The Permittee shall submit monitoring results in accordance with the limits and monitoring requirements for this station. If conditions are such that no sample can be acquired, the Permittee shall report "No Flow" or "No Discharge" on Discharge Monitoring Report (DMR) and shall add a Comments attachment to the DMR detailing why the sample was not collected. [Minn. R. 7001.0150, Subp. 2(B)]
WS 001	Influent Waste	
		Waste Stream: Large Subsurface Sewage Treatment System Influent Monitoring Requirements
	5.2.1	The Permittee shall submit a monthly DMR : Due by 21 days after the end of each calendar month following permit issuance. [Minn. R. 7001.0150, Subp. 2(B)], Phases: Phase 1, Phase 2, Phase 3
	5.2.2	Sampling Location. [Minn. R. 7001.0150, Subp. 2(B)]
	5.2.3	Samples for Station WS 001 shall be taken at point that is representative of total influent flow from the 2 bedroom home. [Minn. R. 7001.0150, Subp. 2(B)]
	5.2.4	The Permittee shall submit monitoring results in accordance with the limits and monitoring requirements for this station. If conditions are such that no sample can be acquired, the Permittee shall report "No Flow" or "No Discharge" on Discharge Monitoring Report (DMR) and shall add a Comments attachment to the DMR detailing why the sample was not collected. [Minn. R. 7001.0150, Subp. 2(B)]
WS 002	Internal Waste Stream	
		Waste Stream: Drainfield Septic Tank Requirements
	5.3.1	The Permittee shall submit a monthly DMR : Due by 21 days after the end of each calendar month following permit issuance. [Minn. R. 7001.0150, Subp. 2(B)]
	5.3.2	Sampling Location. [Minn. R. 7001.0150, Subp. 2(B)]
	5.3.3	Samples for Station WS 002 shall be taken at the last septic tank for the 2 bedroom house. [Minn. R. 7001.0150, Subp. 2(B)]
	5.3.4	The Permittee shall submit monitoring results in accordance with the limits and monitoring requirements for this station. If conditions are such that no sample can be acquired, the Permittee shall report "No Flow" or "No Discharge" on Discharge Monitoring Report (DMR) and shall add a Comments attachment to the DMR detailing why the sample was not collected. [Minn. R. 7001.0150, Subp. 2(B)]
WS 003	Influent Waste	
		Waste Stream: Large Subsurface Sewage Treatment System Influent Monitoring Requirements

	5.4.1	The Permittee shall submit a monthly DMR : Due by 21 days after the end of each calendar month following permit issuance. [Minn. R. 7001.0150, Subp. 2(B)], Phases: Phase 1, Phase 2, Phase 3
	5.4.2	Sampling Location. [Minn. R. 7001.0150, Subp. 2(B)]
	5.4.3	Samples for Station WS 003 shall be taken at a point representative of the total influent flow for the 5 bedroom house. [Minn. R. 7001.0150, Subp. 2(B)]
	5.4.4	The Permittee shall submit monitoring results in accordance with the limits and monitoring requirements for this station. If conditions are such that no sample can be acquired, the Permittee shall report "No Flow" or "No Discharge" on Discharge Monitoring Report (DMR) and shall add a Comments attachment to the DMR detailing why the sample was not collected. [Minn. R. 7001.0150, Subp. 2(B)]
WS 004	Internal Waste Stream	
		Waste Stream: Drainfield Septic Tank Requirements
	5.5.1	The Permittee shall submit a monthly DMR : Due by 21 days after the end of each calendar month following permit issuance. [Minn. R. 7001.0150, Subp. 2(B)]
	5.5.2	Sampling Location. [Minn. R. 7001.0150, Subp. 2(B)]
	5.5.3	Samples for Station WS 004 shall be taken at the last septic tank at the 5 bedroom home. [Minn. R. 7001.0150, Subp. 2(B)]
	5.5.4	The Permittee shall submit monitoring results in accordance with the limits and monitoring requirements for this station. If conditions are such that no sample can be acquired, the Permittee shall report "No Flow" or "No Discharge" on Discharge Monitoring Report (DMR) and shall add a Comments attachment to the DMR detailing why the sample was not collected. [Minn. R. 7001.0150, Subp. 2(B)]
WS 005	Influent Waste	
		Waste Stream: Large Subsurface Sewage Treatment System Influent Monitoring Requirements
	5.6.1	The Permittee shall submit a monthly DMR : Due by 21 days after the end of each calendar month following permit issuance. [Minn. R. 7001.0150, Subp. 2(B)], Phases: Phase 3
	5.6.2	Sampling Location. [Minn. R. 7001.0150, Subp. 2(B)]
	5.6.3	Samples for Station WS 005 shall be taken at a point representative of the influent flow to the horse barn. [Minn. R. 7001.0150, Subp. 2(B)]
	5.6.4	The Permittee shall submit monitoring results in accordance with the limits and monitoring requirements for this station. If conditions are such that no sample can be acquired, the Permittee shall report "No Flow" or "No Discharge" on Discharge Monitoring Report (DMR) and shall add a Comments attachment to the DMR detailing why the sample was not collected. [Minn. R. 7001.0150, Subp. 2(B)]
WS 006	Internal Waste Stream	
		Waste Stream: Drainfield Septic Tank Requirements
	5.7.1	The Permittee shall submit a monthly DMR : Due by 21 days after the end of each calendar month following permit issuance. [Minn. R. 7001.0150, Subp. 2(B)], Phases: Phase 3
	5.7.2	Sampling Location. [Minn. R. 7001.0150, Subp. 2(B)]
	5.7.3	Samples for Station WS 006 shall be taken in the last septic tank at the horse barn. [Minn. R. 7001.0150, Subp. 2(B)]

	5.7.4	The Permittee shall submit monitoring results in accordance with the limits and monitoring requirements for this station. If conditions are such that no sample can be acquired, the Permittee shall report "No Flow" or "No Discharge" on Discharge Monitoring Report (DMR) and shall add a Comments attachment to the DMR detailing why the sample was not collected. [Minn. R. 7001.0150, Subp. 2(B)]
WS 007	Influent Waste	
		Waste Stream: Large Subsurface Sewage Treatment System Influent Monitoring Requirements
	5.8.1	The Permittee shall submit a monthly DMR : Due by 21 days after the end of each calendar month following permit issuance. [Minn. R. 7001.0150, Subp. 2(B)], Phases: Phase 2, Phase 3
	5.8.2	Sampling Location. [Minn. R. 7001.0150, Subp. 2(B)]
	5.8.3	Samples for Station WS 007 shall be taken at a point representative of total influent flow to the pool system. [Minn. R. 7001.0150, Subp. 2(B)]
	5.8.4	The Permittee shall submit monitoring results in accordance with the limits and monitoring requirements for this station. If conditions are such that no sample can be acquired, the Permittee shall report "No Flow" or "No Discharge" on Discharge Monitoring Report (DMR) and shall add a Comments attachment to the DMR detailing why the sample was not collected. [Minn. R. 7001.0150, Subp. 2(B)]
WS 008	Internal Waste Stream	
		Waste Stream: Drainfield Septic Tank Requirements
	5.9.1	The Permittee shall submit a monthly DMR : Due by 21 days after the end of each calendar month following permit issuance. [Minn. R. 7001.0150, Subp. 2(B)], Phases: Phase 2, Phase 3
	5.9.2	Sampling Location. [Minn. R. 7001.0150, Subp. 2(B)]
	5.9.3	Samples for Station WS 008 shall be taken at septic tank #4 of the pool system. [Minn. R. 7001.0150, Subp. 2(B)]
	5.9.4	The Permittee shall submit monitoring results in accordance with the limits and monitoring requirements for this station. If conditions are such that no sample can be acquired, the Permittee shall report "No Flow" or "No Discharge" on Discharge Monitoring Report (DMR) and shall add a Comments attachment to the DMR detailing why the sample was not collected. [Minn. R. 7001.0150, Subp. 2(B)]
MN0071501	YMCA of the Greater Twin Cities	
		Groundwater Station General Requirements
	5.10.1	Analysis Requirements. [Minn. R. 7001]
	5.10.2	If the Permittee is required to monitor for the following parameters: Dissolved Oxygen, pH, Specific Conductance, Temperature and Total Residual Chlorine analyses shall be conducted within 15 minutes of Sample collection. [Minn. R. 7053]
	5.10.3	Monitoring Wells. [Minn. R. 7001]
	5.10.4	The Permittee shall install, maintain and abandon groundwater monitoring wells according to the Minnesota Water Well Construction Code, Minnesota Rules, ch. 4725. Damaged or improperly constructed monitoring wells shall be repaired or properly abandoned and replaced. Information on licensed water well contractors is available from the Minnesota Department of Health. [Minn. R. 4725]

5.10.5	The Permittee shall submit a detailed monitoring well log for each monitoring well at the facility and a detailed US Geological Survey topographical map identifying the location of each well. [Minn. R. 7001]
5.10.6	Each monitoring well shall be clearly numbered on the outside of the well with either indelible paint or an inscribed number. [Minn. R. 7001]
5.10.7	The monitoring wells shall be sampled in accordance with "Minnesota Pollution Control Agency, Water Quality Division: Sampling Procedures for Ground Water Monitoring Wells, July 1997, Reviewed and re-approved September 2006" or any updates to this document. A copy of this publication is available on the MPCA website at: http://www.pca.state.mn.us . [Minn. R. 7001]
5.10.8	Grab samples shall be collected at all ground water monitoring points (lysimeters or wells) after stabilization tests are conducted. [Minn. R. 7001]
5.10.9	Prior to well purging and sampling, depths to groundwater shall be measured to the nearest 0.01 foot below the top of the well casing, and groundwater elevations shall be reported to the nearest 0.01 foot above mean sea level. [Minn. R. 7001]
5.10.10	Temperature, specific conductance and pH shall be reported as the final field measurements from well stabilization. [Minn. R. 7001]
	Waste Stream Station General Requirements
5.11.11	Analysis Requirements. [Minn. R. 7001]
5.11.12	If the Permittee is required to monitor for the following parameters: Dissolved Oxygen, pH, Specific Conductance, Temperature and Total Residual Chlorine analyses shall be conducted within 15 minutes of Sample collection. [Minn. R. 7053]
5.11.13	Representative Samples. [Minn. R. 7001]
5.11.14	Grab and composite samples shall be collected at a point representative of total influent flow to the system. [Minn. R. 7001]
5.11.15	Nitrogen Limits and Monitoring Requirements. [Minn. R. 7001]
5.11.16	"Total Nitrogen" is to be reported as the summation of the Total Kjeldahl Nitrogen and Total Nitrite plus Nitrate Nitrogen values. [Minn. R. 7001]
	Special Requirements
5.12.17	The Permittee shall install influent flow equipment at both the 2 bedroom and 5 bedroom homes. The equipment shall be installed within 1 year of permit issuance. install equipment : Due by one year after permit issuance. [Minn. R. 7001]
5.12.18	The Permittee shall notify the MPCA in writing within 30 days of installation of the influent flow equipment at the 2 bedroom and 5 bedroom homes. notify MPCA : Due within 30 days. [Minn. R. 7001]
5.12.19	The Permittee shall install a piezometer to measure depth to groundwater within the 5 bedroom home drainfield. The piezometer shall be installed within 1 year of permit issuance. install : Due by one year after permit issuance. [Minn. R. 7001]
5.12.20	The Permittee shall notify MPCA in writing within 30 days of the installation of the piezometer within the 5 bedroom home drainfield system. notify MPCA : Due within 30 days. [Minn. R. 7001]

5.12.21	<p>The Permittee shall submit an annual report 1 year after permit issuance. The report shall include but not be limited to:</p> <ul style="list-style-type: none"> a) a discussion for the past year's flow monitoring, b) a discussion on whether the flow data indicates a need for the construction of a 2nd mound, c) if additional capacity is needed, then the permittee shall submit an application for a permit modification, d) the permit modification should include a soils and groundwater evaluation, e) the evaluation of the groundwater should propose the number and locations of ground water monitoring wells, f) this report would be the trigger to start the construction of the 2nd mound system. submit an annual report : Due by one year after permit issuance. [Minn. R. 7001]
	Construction Schedule
5.13.22	Definitions. [Minn. R. 7001]
5.13.23	"Initiation of operation" means the date that MPCA determines all components of the wastewater treatment system are complete and functioning and the project begins operating for the purposes for which it was planned, designed, and built. [Minn. R. 7001]
5.13.24	"Completion of construction" means all the construction is complete except for minor weather-related components and conforms to the approved plans and specifications and change orders. [Minn. R. 7001]
5.13.25	"Notice to proceed" means a written notice given by the Permittee to the contractor that affixes the contract effective date and the date that the contractor begins performing the work specified in the contract documents. [Minn. R. 7001]
5.13.26	Schedule. [Minn. R. 7001]
5.13.27	Submit Notice to Proceed. The Permittee shall submit a copy of the Notice to Proceed in the Phase 1 of the pool facility to the MPCA within 14 days of its execution. [Minn. R. 7001]
5.13.28	Submit Verification of Certified Operator and O&M Manual. The Permittee shall notify the MPCA in writing at least 60 days before the planned initiation of operation of the new or upgraded facility that it has employed a wastewater treatment facility operator, certified for the classification of the treatment system (according to Minn. R., Chapter 9400), that is directly responsible for the operation of the system. The Permittee shall also submit an operation and maintenance (O&M) manual or a maintenance plan; or a certificate of completion of an operation and maintenance manual. [Minn. R. 7001]
5.13.29	Submit Notice of Intent to Initiate Operation. The Permittee shall notify the MPCA in writing at least 14 days before the planned initiation of operation date of the Phase 1 for the pool facility. Following MPCA staff concurrence that the facility is adequately prepared, MPCA staff will notify the Permittee that it may initiate operation of the new or upgraded facility. [Minn. R. 7001]
5.13.30	Submit Initiation of Operation Date. The Permittee shall notify the MPCA in writing within 14 days after the actual initiation of operation date of the Phase 1 pool facility. The Permittee shall comply with all permit requirements and attain final limits within 90 days of the Initiation of Operation date. [Minn. R. 7001]
5.13.31	Submit Notice to Complete Construction. The Permittee shall notify the MPCA in writing at least 14 days before the planned completion of construction date of the Phase 1 pool facility. The MPCA may complete a final inspection. [Minn. R. 7001]

5.13.32	<p>Submit Final Technical Documents. The Permittee shall submit the following to the MPCA within one year after the initiation of operation date:</p> <p>a. An MPCA-approved certification form that is signed by a professional engineer registered in the state of Minnesota stating that the project meets the performance standards.</p> <p>b. A revised operation and maintenance manual or a maintenance plan; or a certificate of completion of an operation and maintenance manual on a form prescribed by the MPCA. At a minimum, this plan shall include a detailed discussion of operation and controls, maintenance, sampling and analysis, problem mitigation, VOC management, personnel records and reporting, and safety. This plan shall be maintained and updated regularly and made available to the MPCA staff upon request.</p> <p>c. A system effectiveness evaluation that summarizes the effectiveness of the treatment facility (including any applicable groundwater monitoring system) as detailed in the plan and specifications approval letter or through communication with the MPCA staff.</p> <p>d. One copy of "as-built" plans and specifications, also known as record drawings, shall be submitted in a format approved by the MPCA. The factsheet titled: "Wastewater Treatment Facility Construction Record Documents, As-built Submittal Requirements" contains specific information regarding the required format of the submittal. The document is located on the MPCA web page at: http://www.pca.state.mn.us/index.php/view-document.html?gid=15492. [Minn. R. 7001]</p>
5.13.33	<p>Submit Notice to Proceed. The Permittee shall submit a copy of the Notice to Proceed on the horse barn system to the MPCA within 14 days of its execution. [Minn. R. 7001]</p>
5.13.34	<p>Submit Notice of Intent to Initiate Operation. The Permittee shall notify the MPCA in writing, for the horse barn facility, at least 14 days before the planned initiation of operation date. Following MPCA staff concurrence that the facility is adequately prepared, MPCA staff will notify the Permittee that it may initiate operation of the new or upgraded facility. [Minn. R. 7001]</p>
5.13.35	<p>Submit Initiation of Operation Date. The Permittee shall notify the MPCA in writing within 14 days after the actual initiation of operation date of the horse barn facility. The Permittee shall comply with all permit requirements and attain final limits within 90 days of the initiation of Operation date. [Minn. R. 7001]</p>
5.13.36	<p>Submit Notice to Complete Construction. The Permittee shall notify the MPCA in writing at least 14 days before the planned completion of construction date of the horse barn facility. The MPCA may complete a final inspection. [Minn. R. 7001]</p>
5.14.37	<p>Septic Tanks Septic Tank Maintenance. [Minn. R. 7001]</p>
5.14.38	<p>All tanks (primary, secondary, holding, dosing, individual, etc.) associated with this system shall be operated, pumped and maintained to ensure proper system operation and solids management. After every pumping event, all tanks shall be inspected for potential failure (such as cracks, roots, damaged baffles, etc.). Identified problems shall be corrected immediately. [Minn. R. 7001.0150, 3(F)]</p>
5.14.39	<p>The owner of a septic tank or tanks or the owner's agent shall arrange for the removal and proper disposal of septage from all tanks or compartments in which the top of the sludge layer is less than 12 inches below the bottom of the outlet baffle or whenever the bottom of the scum layer is less than three inches above the outlet baffle. All accumulations of sludge, scum, and liquids shall be removed through the maintenance hole. [Minn. R. 7001.0150, 3(F)]</p>

5.14.40	The Permittee shall properly clean the effluent screens as often as needed to maintain an adequate flow rate from the septic tank(s). The Permittee shall keep a record at the facility that indicates the dates that the effluent screens are inspected, removed and cleaned. [Minn. R. 7001.0150, 3(F)]
5.14.41	Tanks that are not specifically covered under the Limits & Monitoring section of this permit shall be inspected at least every three years and pumped as necessary unless more restrictive local requirements have been established. [Minn. R. 7001.0150, 3(F)]
	Large Subsurface Treatment System (LSTS)
5.15.42	Unauthorized Discharge. [Minn. R. 7001]
5.15.43	There shall be no unauthorized discharge to the ground surface or surface water from these facilities. [Minn. R. 7001.0030]
5.15.44	Prohibitions. [Minn. R. 7001]
5.15.45	The Permittee shall prevent the discharge of any wastes other than sewage into any component of the facility, including septic tanks, advanced treatment systems, and soil treatment systems that could result in damage to the treatment facility or inhibit treatment unless the discharge of such other substances is specifically approved in writing by the MPCA. [Minn. R. 7001]
5.15.46	Sanitary Sewer Extension Permit. [Minn. R. 7001]
5.15.47	The Permittee may be required to obtain a Sanitary Sewer Extension Permit from the MPCA for any addition, extension or replacement to the sanitary sewer. If a sewer extension permit is required, construction may not begin until plans and specifications have been submitted and a written permit is granted except as allowed in Minn. Stat. 115.07, Subd. 3(b). [Minn. R. 7001.0020, D]
5.15.48	Operator Certification. [Minn. R. 7001]
5.15.49	The Permittee shall provide a Class D state certified operator who is in direct responsible charge of the operation, maintenance and testing functions required to ensure compliance with the terms and conditions of this permit. [Minn. R. 9400]
5.15.50	The certified operator shall also become certified as a Service Provider within two years of permit issuance. Copies of the certificate of attendance and the exam results indicating a passing score shall be submitted to the agency within 2.5 years after permit issuance. Equivalent training may be allowed but shall be pre-approved by the MPCA. [Minn. R. 7001.0150, Subp. 3(F)]
5.15.51	The Permittee shall submit a copy of the certification card : Due by 2.5 years after permit issuance The copy of the Service Provider's Subsurface Sewage Treatment System (SSTS) Individual Certification Card shall display the Certification Number and be sent to the MPCA, Attn: WQ Submittals Center. [Minn. R. 7001.0150, Subp. 3(F)]
5.15.52	If the Permittee chooses to meet operator certification requirements through a contractual agreement, the Permittee shall provide a copy of the contract to the MPCA, WQ Submittals Center. The contract shall include the certified operator's name, certificate number, service provider certification number, company name if appropriate, the period covered by the contract and provisions for renewal; the duties and responsibilities of the certified operator; the duties and responsibilities of the permittee; and provisions for notifying the MPCA 30 days in advance of termination if the contract is terminated prior to the expiration date. [Minn. R. 9400]
5.15.53	The Permittee shall notify the MPCA within 30 days of a change in operator certification or contract status. [Minn. R. 9400]
5.15.54	Special Requirements. [Minn. R. 7001]
5.15.55	Special Condition - Update O & M Manual. [Minn. R. 7001]
5.15.56	The Permittee is required to have on-site and available an updated Operation and Maintenance manual. This manual shall be available to MPCA staff upon request. [Minn. R. 7001.0150, Subp. 3(F)]

5.15.57	Facility Maintenance. [Minn. R. 7001]
5.15.58	The facility shall be adequately protected to prevent damage. [Minn. R. 7001.0150, Subp. 3(F)]
5.15.59	Collection System. [Minn. R. 7001]
5.15.60	The collection system shall be properly maintained to minimize inflow, infiltration, exfiltration, and obstructions. A record of all inspections and maintenance operations shall be kept by the Permittee for a minimum of three years. [Minn. R. 7001.0150, Subp. 3(F)]
5.15.61	Soil Treatment System Maintenance. [Minn. R. 7001]
5.15.62	The soil treatment system(s) shall be adequately fenced. [Minn. R. 7001.0150, Subp. 3(F)]
5.15.63	A dense vegetative cover shall be maintained over the soil treatment system(s) at all times during the growing season to prevent the growth of unwanted vegetation such as trees, deep rooted nuisance plants, aquatic vegetation and to prevent erosion. [Minn. R. 7001.0150, Subp. 3(F)]
5.15.64	Routine maintenance shall be conducted to discourage the presence of rodents and other burrowing animals and deer on the soil treatment system and to allow inspection of observation ports installed in the soil treatment system(s) inspection pipes. [Minn. R. 7001.0150, Subp. 3(F)]
5.15.65	Soil Treatment System Inspection. [Minn. R. 7001]
5.15.66	Ponding depth inspections to determine the condition of each soil treatment system (trench, bed, at-grade, mound, or drip dispersal) /drainfield standpipe shall be conducted every other month during the time the soil treatment system is in use. The inspection of each soil treatment system shall include the identification of wet or saturated areas, depth of effluent ponding in the soil treatment observation ports, evidence of effluent at the surface, frozen components, and measurements in piezometers (if installed). Visual observations shall be recorded and inspection records shall be maintained by the owner for a minimum of three years following each inspection. The results of the inspection are not required to be submitted to the MPCA but shall be made available upon request by MPCA staff. [Minn. R. 7001.0150, Subp. 3(F)]
5.15.67	Indications of excessive hydraulic and organic loading to the wastewater treatment facility flow rate include ineffective septic tanks or advanced treatment systems, prolonged saturated soil conditions, vegetative drowning or excessive ground water mounding (observed from piezometers) and exceeding daily permitted flow rates as indicated by flow meters, event counters and running time clocks. [Minn. R. 7001.0150, Subp. 3(F)]
5.15.68	Reserve Soil Treatment System. [Minn. R. 7001]
5.15.69	The reserve area for the soil treatment system/drainfield shall be properly protected to prevent the use of, and damage to, the area. The reserve area shall be posted and identified for the public with at least one sign designating its future purpose and the boundaries shall be visibly staked at all corners. In no case may this area be disturbed for any purpose, including vehicle traffic, storage, bike, hiking or ATV trails, playing fields, etc. [Minn. R. 7001.0150, Subp. 3(F)]
	Total Facility Requirements (SDS)
5.16.70	No Discharge. There shall be no point source discharge to surface water from the permitted activity. [Minn. R. 7001]
5.16.71	Definitions. Refer to the Permit User's Manual found on the MPCA's website (https://www.pca.state.mn.us) for standard definitions. [Minn. R. 7001]

5.16.72	Incorporation by Reference. This permit incorporates the following applicable federal and state laws applicable to the Permittee and enforceable parts of this permit: 40 CFR pts. 122.41, 122.42, 136, 403 and 503; Minn. R. chs. 7001, 7041, 7045, 7050, 7052, 7053, 7060, and 7080; and Minn. Stat. chs. 115 and 116. [Minn. R. 7001]
5.16.73	Permittee Responsibility. The Permittee shall perform the actions or conduct the activity authorized by this permit in compliance with the conditions of the permit and, if required, in accordance with the plans and specifications approved by the MPCA. [Minn. R. 7001.0150, subp. 3(E)]
5.16.74	Toxic Discharges Prohibited. Whether or not this permit includes effluent limitations for toxic pollutants, the Permittee shall not discharge a toxic pollutant except according to 40 CFR pts. 400 to 460 and Minn. R. chs. 7050, 7052, 7053 and any other applicable MPCA rules. [Minn. R. 7001.1090, subp. 1(A)]
5.16.75	Nuisance Conditions Prohibited. The Permittee's discharge shall not cause any nuisance conditions including, but not limited to: floating solids, scum and visible oil film, excessive suspended solids, material discoloration, obnoxious odors, gas ebullition, deleterious sludge deposits, undesirable slimes or fungus growths, aquatic habitat degradation, excessive growths of aquatic plants, acutely toxic conditions to aquatic life, or other adverse impact on the receiving water. [Minn. R. 7050.0210, subp. 2]
5.16.76	Property Rights. This permit does not convey a property right or an exclusive privilege. [Minn. R. 7001.0150, subp. 3(C)]
5.16.77	Liability Exemption. In issuing this permit, the State and the MPCA assume no responsibility for damage to persons, property, or the environment caused by the activities of the Permittee in the conduct of its actions, including those activities authorized, directed, or undertaken under this permit. To the extent the State and the MPCA may be liable for the activities of its employees, that liability is explicitly limited to that provided in the Tort Claims Act. [Minn. R. 7001.0150, subp. 3(O)]
5.16.78	The MPCA's issuance of this permit does not obligate the MPCA to enforce local laws, rules, or plans beyond what Minnesota statutes authorize. [Minn. R. 7001.0150, subp. 3(D)]
5.16.79	Liabilities. The MPCA's issuance of this permit does not release the Permittee from any liability, penalty, or duty imposed by Minnesota or federal statutes or rules or local ordinances, except the obligation to obtain the permit. [Minn. R. 7001.0150, subp. 3(A)]
5.16.80	The issuance of this permit does not prevent the future adoption by the MPCA of pollution control rules, standards, or orders more stringent than those now in existence and does not prevent the enforcement of these rules, standards, or orders against the Permittee. [Minn. R. 7001.0150, subp. 3(B)]
5.16.81	Severability. The provisions of this permit are severable and, if any provisions of this permit or the application of any provision of this permit to any circumstance are held invalid, the application of such provision to other circumstances and the remainder of this permit shall not be affected thereby. [Minn. R. 7001]
5.16.82	Compliance with Other Rules and Statutes. The Permittee shall comply with all applicable air quality, solid waste, and hazardous waste statutes and rules in the operation and maintenance of the facility. [Minn. R. 7001]

5.16.83	<p>Inspection and Entry. When authorized by Minn. Stat. ch. 115.04, 115B.17, subd. 4, and 116.091, and upon presentation of proper credentials, the Permittee shall allow the MPCA, or an authorized employee or agent of the MPCA, to enter at reasonable times upon the property of the Permittee to examine and copy books, papers, records, or memoranda pertaining to the construction, modification, or operation of the facility covered by the permit or pertaining to the activity covered by the permit; and to conduct surveys and investigations, including sampling or monitoring, pertaining to the construction, modification, or operation of the facility covered by the permit or pertaining to the activity covered by the permit. [Minn. R. 7001.0150, subp. 3(I)]</p>
5.16.84	<p>Control Users. The Permittee shall regulate the users of its facility to prevent the introduction of pollutants or materials that may result in the inhibition or disruption of the conveyance system, treatment facility or processes, or disposal system that would contribute to the violation of the conditions of this permit or any federal, state, or local law or regulation. [Minn. R. 7001.0150, subp. 3(F)]</p>
5.16.85	<p>Sampling. [Minn. R. 7001]</p>
5.16.86	<p>Representative Sampling. The Permittee shall conduct samples and measurements required by this permit as specified in this permit and shall be representative of the discharge or monitored activity. [Minn. R. 7001.0150, subp. 2(B)]</p>
5.16.87	<p>Additional Sampling. If the Permittee monitors more frequently than required, they shall report the results and the frequency of monitoring on their eDMR for that reporting period. [Minn. R. 7001.1090, subp. 1(E)]</p>
5.16.88	<p>Certified/Accredited Laboratory. A laboratory accredited by the Minnesota Department of Health [Minn. R. 4740.2010 through Minn. R. 4740.2120] and/or certified by the MPCA [Minn. R. 7001.4310 through Minn. R. 7001.4390] shall conduct analyses required by this permit, unless approved in writing by the MPCA. A certified/accredited laboratory does not need to complete analyses of dissolved oxygen, pH, temperature, specific conductance, and total residual oxidants (chlorine, bromine). Those analyses shall comply with 40 CFR pt. 136. Dissolved oxygen, pH, and total residual oxidants must be performed on-site. Follow the manufacturer's specifications for equipment maintenance and use. [Minn. R. 4740.2010-4740.2120, Minn. R. 7001.4310-7001.4390]</p>
5.16.89	<p>Sample Preservation and Procedure. Sample preservation and test procedures for the analysis of pollutants shall conform to 40 CFR pt. 136 and Minn. R. 7041.3200. [Minn. R. 7001.0150, subp. 2(B), Minn. R. 7041.3200]</p>
5.16.90	<p>Equipment Calibration. The Permittee shall check and/or calibrate flow meters, pumps, flumes, lift stations, or other flow monitoring equipment used for purposes of determining compliance (within plus or minus ten percent of the true flow values) with permit requirements at least twice annually. [Minn. R. 7001.0150, subp. 2(B & C)]</p>
5.16.91	<p>Maintain Records. The Permittee shall keep the records required by this permit for at least three years, including any calculations, original recordings from automatic monitoring instruments, and laboratory sheets. The Permittee shall extend these record retention periods upon request of the MPCA. The Permittee shall maintain records for each sample and measurement. The records shall include the following information:</p> <ul style="list-style-type: none">A. The exact place, date, and time of the sample or measurement;B. The date of analysis;C. The name of the person who performed the sample collection, measurement, analysis, or calculation;D. The analytical techniques, procedures, and methods used; andE. The results of the analysis. [Minn. R. 7001.0150, subp. 2(C)]

5.16.92	<p>Completing Reports. The Permittee shall submit the results of the required sampling and monitoring activities on the forms provided, specified, or approved by the MPCA. The Permittee shall record the information in the specified areas on those forms and in the units specified.</p> <p>Required forms may include a Sample Values Form. If required, the Permittee shall record individual values for each sample and measurement on the Sample Values Form provided by the MPCA. The Permittee shall submit Sample Values Form with the appropriate eDMRs. The Permittee may design and use their own Sample Values Form; however, the Permittee shall not use their form until the MPCA reviews and approves the form.</p> <p>Note: The Permittee shall also record required summary information on their eDMR. Permittee submitted summary information contained only on the Sample Values Form does not comply with reporting requirements. [Minn. R. 7001.0150, subp. 2(B), Minn. R. 7001.1090, subp. 1(D)]</p>
5.16.93	<p>Submitting Reports. The Permittee shall submit eDMRs, Sample Values Forms, and other supplemental attachment forms via MPCA e-Services after the MPCA approves their authorization request.</p> <p>The Permittee shall electronically submit eDMRs, Sample Values Forms, and other supplemental attachment forms by the 21st day of the month following the sampling period or otherwise as specified in this permit. The Permittee shall complete eDMR submittal on or before 11:59 PM of the 21st day of the month following the sampling period or as otherwise specified in this permit. The Permittee shall submit an eDMR for each required station even if no discharge occurred during the reporting period.</p> <p>The Permittee shall submit other reports required by this permit electronically or by mail. The Permittee shall submit reports by the date specified in this permit. For electronic submittals, the Permittee shall submit on or before 11:59 PM on the date specified in this permit. For mailed submittals, the Permittee shall ensure that submittals via U.S. Postal Service or other hand delivery method contain postmarks by the date specified in this permit. Whole Effluent Testing (WET) and Pretreatment Annual Reports must be mailed to the WQ Submittals Center.</p> <p>Electronically: wq.submittals.mpca@state.mn.us Include Water quality submittals form: www.pca.state.mn.us/sites/default/files/wq-wwprm7-71.docx</p> <p>Or by mail: Attention: WQ Submittals Center Minnesota Pollution Control Agency 520 Lafayette Road North St. Paul, MN 55155-4191. [Minn. R. 7001.0150, subp. 2(B), Minn. R. 7001.0150, subp. 3(H)]</p>
5.16.94	<p>Incomplete or Incorrect Reports. The Permittee shall immediately submit an electronically amended report or eDMR to the MPCA upon discovery by the Permittee or notification by the MPCA that it has submitted an incomplete or incorrect report or eDMR. The amended report or eDMR shall contain the missing or corrected data along with a comment on the eDMR explaining the circumstances of the incomplete or incorrect report. If it is impossible to amend the report or eDMR electronically, the Permittee shall immediately notify the MPCA and the MPCA will provide direction for the amendment submittals. [Minn. R. 7001.0150, subp. 3(G)]</p>

5.16.95	Required Signatures. The Permittee or the duly authorized representative of the Permittee shall sign all eDMRs, forms, reports, and other documents submitted to the MPCA per Minn. R. 7001.0150, subp. 2(D). The person or persons who sign the eDMRs, forms, reports, or other documents shall certify that he or she understands and complies with the certification requirements of Minn. R. chs. 7001.0070 and 7001.0540, including the penalties for submitting false information. A registered professional engineer shall certify technical documents, such as design drawings and specifications, and engineering studies submitted as part of a permit application or by permit conditions. [Minn. R. 7001.0540]
5.16.96	Reporting Limit (RL). The Permittee shall report monitoring results below the RL of a particular instrument as "<" the value of the RL. For example, if an instrument has a RL of 0.1 mg/L and a parameter is not detected at a value of 0.1 mg/L or greater, the Permittee shall report the concentration as "< 0.1 mg/L." The Permittee shall not use "non-detected," "undetected," "below detection limit," or "zero" when reporting results. The MPCA considers these terms as permit reporting violations. Where sample values are less than the RL and the permit requires reporting of an average, the Permittee shall calculate the average as follows: A. If some values are less than (<) the RL, substitute zero for all non-detectable values to use in the average calculation; B. If all values are less than (<) the RL, calculate the average and report as < the RL average concentration; and C. To calculate a mass loading with a less than (<) the RL concentration, use the RL value in the calculation and then add the "<" to the product of the concentration and the volume. [Minn. R. 7001.0150, subp. 2(B)]
5.16.97	Records. The Permittee shall, when requested by the MPCA, submit within a reasonable time the information and reports that are relevant to the control of pollution regarding the construction, modification, or operation of the facility covered by the permit or regarding the conduct of the activity covered by the permit. [Minn. R. 7001.0150, subp. 3(H)]
5.16.98	Confidential Information. Except for data determined to be confidential according to Minn. Stat. ch. 116.075, subd. 2, all reports required by this permit are available for public inspection. The MPCA does not consider effluent data confidential. To request the MPCA maintain data as confidential, the Permittee shall follow Minn. R. 7000.1300. [Minn. R. 7000.1300]
5.16.99	Noncompliance and Enforcement. [Minn. R. 7001]
5.16.100	Subject to Enforcement Action and Penalties. Noncompliance with a term or condition of this permit subjects the Permittee to penalties provided by federal and state law set forth in section 309 of the Clean Water Act; United States Code, title 33, section 1319, as amended; and in Minn. Stat. ch. 115.071 and 116.072, including monetary penalties, imprisonment, or both. [Minn. R. 7001.1090, subp. 1(B)]
5.16.101	Criminal Activity. The Permittee shall not knowingly make a false statement, representation, or certification in a record or other document submitted to the MPCA. A person who falsifies a report or document submitted to the MPCA, or tampers with, or knowingly renders inaccurate a monitoring device or method that requires maintenance under this permit is subject to criminal and civil penalties provided by federal and state law. [Minn. R. 7001.0150, subp. 3(G), Minn. R. 7001.1090, subp. 1(G & H), Minn. Stat. ch. 609.671, subd. 1]
5.16.102	Noncompliance Defense. It shall not be a defense for the Permittee in an enforcement action that it would have been necessary to halt or reduce the permitted activity in order to maintain compliance with the conditions of this permit. [40 CFR 122.41(c)]

5.16.103	<p>Effluent Violations. If sampling by the Permittee indicates a violation of any discharge limitation specified in this permit, the Permittee shall immediately make every effort to verify the violation by collecting additional samples, if appropriate, investigate the cause of the violation, and take action to prevent future violations.</p> <p>If the Permittee discovers that noncompliance with a condition of the permit occurred and that the noncompliance could endanger human health, public drinking water supplies, or the environment, the Permittee shall within 24 hours of the discovery of the noncompliance orally notify the Commissioner and submit a written description of the noncompliance within five days of the discovery.</p> <p>If the Permittee discovers other noncompliance that does not explicitly endanger human health, public drinking water supplies, or the environment, the Permittee shall report the description of noncompliance within 30 days of the discovery. If no eDMR is required within 30 days, the Permittee shall submit a written report including the description of noncompliance within 30 days of the discovery of the noncompliance. This description shall include the following information:</p> <ul style="list-style-type: none">A. A description of the event including volume, duration, monitoring results, and receiving waters;B. The cause of the event;C. The steps taken to reduce, eliminate, and prevent reoccurrence of the event;D. The exact dates and times of the event; andE. Steps taken to reduce any adverse impact resulting from the event. [Minn. R. 7001.0150, subp. 3(K)]
5.16.104	<p>Upset Defense. In the event of temporary noncompliance with applicable effluent limitation(s) resulting from an upset at the Permittee's facility due to factors beyond the control of the Permittee, the Permittee has an affirmative defense to an enforcement action brought by the MPCA as a result of the noncompliance if the Permittee demonstrates by a preponderance of competent evidence:</p> <ul style="list-style-type: none">A. The specific cause of the upset;B. That the upset was unintentional;C. That the upset resulted from factors beyond the reasonable control of the Permittee and did not result from operational error, improperly designed treatment facilities, inadequate treatment facilities, lack of preventative maintenance, or increases in production which are beyond the design capability of the treatment facilities;D. That at the time of the upset the facility was being properly operated;E. That the Permittee properly notified the Commissioner of the upset in accordance with Minn. R. 7001.1090, subp. 1(I); andF. That the Permittee implemented the remedial measures required by Minn. R. 7001.0150, subp. 3(J). [Minn. R. 7001.1090]
5.16.105	<p>Release. [Minn. R. 7001]</p>
5.16.106	<p>Unauthorized Releases of Wastewater Prohibited. This permit prohibits overflows, discharges, spills, or other releases of wastewater or materials to the environment, whether intentional or not, except for discharges from outfalls specifically authorized by this permit. The MPCA will consider the Permittee's compliance with permit requirements, frequency of release, quantity, type, location, and other relevant factors when determining appropriate action. [40 CFR 122.41, Minn. Stat. ch. 115.061]</p>

5.16.107	<p>Discovery of a Release. Upon discovery of a release, the Permittee shall:</p> <p>A. Take all reasonable steps to immediately end the release;</p> <p>B. Notify the Minnesota Department of Public Safety Duty Officer at 1(800)422-0798 or (651)649-5451 (metro area) immediately upon discovery of the release. The Permittee may contact the MPCA during business hours at 1(800)657-3864 or (651)296-6300 (metro area); and</p> <p>C. Recover as rapidly and as thoroughly as possible all substances and materials released or immediately take other action as may be reasonably possible to minimize or abate pollution to waters of the state or potential impacts to human health caused thereby. If the Permittee cannot immediately or completely recover the released materials or substances, the Permittee shall contact the MPCA. If directed by the MPCA, the Permittee shall consult with other local, state, or federal agencies (such as the Minnesota Department of Natural Resources and/or the Wetland Conservation Act authority) for implementation of additional clean up or remediation activities in wetland or other sensitive areas. [Minn. R. 7001.1090]</p>
5.16.108	<p>Sampling of a Release. Upon discovery of a release, the Permittee shall:</p> <p>A. Collect representative samples of the release. The Permittee shall sample the release for permitted effluent parameters and other parameters of concern immediately following discovery of the release. The Permittee may contact the MPCA during business hours to discuss the sampling parameters and protocol. In addition, the Permittee shall collect fecal coliform bacteria samples where the Permittee determines that the release contains or may contain sewage. If the Permittee cannot immediately stop the release, the Permittee shall consult with the MPCA regarding additional sampling requirements. The Permittee shall collect samples at least, but not limited to, two times per week for as long as the release continues; and</p> <p>B. Submit the sampling results on the Release Report located on the MPCA's website at https://www.pca.state.mn.us/water/discharge-monitoring-reports.</p> <p>The Permittee shall submit the Release Report to the MPCA with the next eDMR or within 30 days, whichever is sooner. [Minn. R. 7001.1090]</p>
5.16.109	<p>Bypass. [Minn. R. 7001]</p>
5.16.110	<p>Anticipated Bypass. The Permittee may allow any bypass to occur that does not cause effluent limitation exceedances, but only if the bypass is for essential maintenance to assure efficient operation of the facility. The Permittee shall submit prior notice to the MPCA at least ten days before the date of the bypass, if possible. The notice of the need for an anticipated bypass shall include the following information:</p> <p>A. The proposed date and estimated duration of the bypass;</p> <p>B. The alternatives to bypassing; and</p> <p>C. A proposal for effluent sampling during the bypass. Any bypass wastewater shall enter waters of the state from outfalls specifically authorized by this permit. Therefore, the Permittee shall collect samples at the frequency and location identified in this permit or two times per week for as long as the bypass continues, whichever is more frequent. [40 CFR 122.41(m)(2 & 3), Minn. R. 7001.1090, subp. 1(J)]</p>

5.16.111	<p>This permit prohibits all other bypasses. The MPCA may take enforcement action against the Permittee for a bypass, unless the specific conditions described in Minn. R. 7001.1090 subp. 1(K) and 40 CFR 122.41(m)(4)(i) are met.</p> <p>In the event of an unanticipated bypass, the Permittee shall:</p> <p>A. Take all reasonable steps to immediately end the bypass;</p> <p>B. Notify the Minnesota Department of Public Safety Duty Officer at 1(800)422-0798 or (651)649-5451 (metro area) immediately upon commencement of the bypass. The Permittee may contact the MPCA during business hours at 1(800)657-3864 or (651)296-6300 (metro area);</p> <p>C. Immediately take action as may be reasonably possible to minimize or abate pollution to waters of the state or potential impacts to human health caused thereby. If directed by the MPCA, the Permittee shall consult with other local, state, or federal agencies for implementation of abatement, clean up, or remediation activities; and</p> <p>D. Only allow bypass wastewater as specified in this section to enter waters of the state from outfalls specifically authorized by this permit. The Permittee shall collect samples at the frequency and location identified in this permit or two times per week for as long as the bypass continues, whichever is more frequent. The Permittee shall also follow the reporting requirements for effluent violations as specified in this permit. [40 CFR 122.41(m)(4)i, Minn. R. 7001.1090, subp. 1(K), Minn. Stat. ch. 115.061]</p>
5.16.112	<p>Operation and Maintenance. [Minn. R. 7001]</p>
5.16.113	<p>The Permittee shall at all times properly operate and maintain the facilities and systems of treatment and control, and the appurtenances related to them which are installed or used by the Permittee to achieve compliance with the conditions of the permit. Proper operation and maintenance includes effective performance, adequate funding, adequate operator staffing and training, and adequate laboratory and process controls, including appropriate quality assurance procedures. The Permittee shall install and maintain appropriate backup or auxiliary facilities if they are necessary to achieve compliance with the conditions of the permit and, for all permits other than hazardous waste facility permits, if these backup or auxiliary facilities are technically and economically feasible. [Minn. R. 7001.0150, subp. 3(F)]</p>
5.16.114	<p>In the event of a reduction or loss of effective treatment of wastewater at the facility, the Permittee shall control production or curtail discharges to the extent necessary to maintain compliance with the terms and conditions of this permit. The Permittee shall continue this control or curtailment until they restore facility treatment processes or until the Permittee provides an alternative method of treatment. [Minn. R. 7001.1090, subp. 1(C)]</p>
5.16.115	<p>Solids Management. The Permittee shall properly store, transport, and manage biosolids, septage, sediments, residual solids, filter backwash, screenings, oil, grease, and other substances so that pollutants do not enter surface waters or groundwaters of the state. The Permittee shall manage solids in accordance with local, state, and federal requirements. [40 CFR 503, Minn. R. 7041]</p>
5.16.116	<p>Scheduled Maintenance. The Permittee shall schedule maintenance of the treatment works during non-critical water quality periods to prevent water quality degradation, except where the facility requires emergency maintenance to prevent a condition that would be detrimental to water quality or human health. [Minn. R. 7001.0150, subp. 2(B), Minn. R. 7001.0150, subp. 3(F)]</p>
5.16.117	<p>Control Tests. The Permittee shall conduct in-plant control tests at a frequency adequate to ensure compliance with the conditions of this permit. [Minn. R. 7001.0150, subp. 2(B), Minn. R. 7001.0150, subp. 3(F)]</p>
5.16.118	<p>Changes to the Facility or Permit. [Minn. R. 7001]</p>

5.16.119	<p>Permit Modifications. Except as provided under Minn. Stat. ch. 115.07, subd. 1 and 3, no person required by statute or rule to obtain a permit may construct, install, modify, or operate the facility to be permitted, nor shall a person commence an activity for which a permit is required by statute or rule until the MPCA issues a written permit for the facility or activity.</p> <p>Permittees that propose to make changes to the facility or discharge that requires permit modification shall follow Minn. R. 7001.0190. If the Permittee cannot determine whether the proposed changes require a permit modification, the Permittee shall contact the MPCA prior to any action. The MPCA recommends that Permittees submit the application for permit modification to the MPCA at least 180 days prior to the planned change. [Minn. R. 7001.0030]</p>
5.16.120	<p>This permit does not require plans, specifications, and MPCA approval when maintenance dictates the need for installation of new equipment, provided the equipment is the same design size and has the same design intent. For instance, Permittees can replace a broken pipe, lift station pump, aerator, or blower with the same design-sized equipment without MPCA approval.</p> <p>If this permit does not expressly authorize the Permittee proposed construction, the MPCA may require a permit modification. If the proposed construction project requires an Environmental Assessment Worksheet under Minn. R. 4410, no construction shall begin until the MPCA issues a negative declaration and the Permittee receives or implements all approvals. [Minn. R. 7001.0030]</p>
5.16.121	<p>Report Changes. The Permittee shall give advance notice as soon as possible to the MPCA of any substantial changes in operational procedures, activities that may alter the nature or frequency of the discharge, and/or material factors that may affect compliance with the conditions of this permit. [Minn. R. 7001.0150, subp. 3(M)]</p>

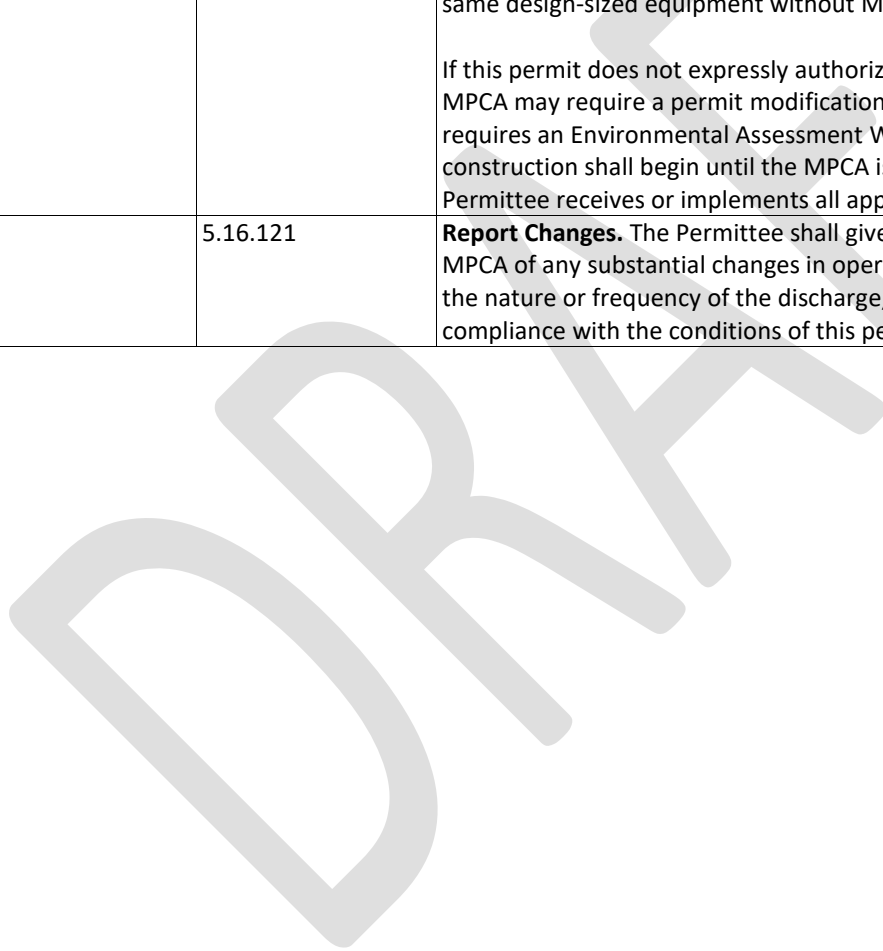

5.16.122	<p>Chemical Additives. The Permittee shall receive prior written approval from the MPCA before increasing the use of a chemical additive authorized by this permit, or using a chemical additive not authorized by this permit, in quantities or concentrations that have the potential to change the characteristics, nature, and/or quality of the discharge.</p> <p>The Permittee shall request approval for an increase or new use of a chemical additive at least 60 days, or as soon as possible, before the proposed increase or new use. The Permittee shall include at least the following information for the proposed additive as instructed in the chemical additive approvals section on the MPCA website at https://www.pca.state.mn.us/water/wastewater-additional-guidance-and-information:</p> <p>A. The process for which the additive will be used; B. Safety Data Sheet (SDS) which shall include aquatic toxicity, human health, and environmental fate information for the proposed additive. The aquatic toxicity information shall include at minimum the results of: a) a 48-hour LC50 or EC50 acute study for a North American freshwater planktonic crustacean (either Ceriodaphnia or Daphnia sp.) and b) a 96-hour LC50 acute study for rainbow trout, bluegill, or fathead minnow or another North American freshwater aquatic species other than a planktonic crustacean; C. A complete product use and instruction label; D. The commercial and chemical names and Chemical Abstract Survey (CAS) number for all ingredients in the additive (If the SDS does not include information on chemical composition, including percentages for each ingredient totaling to 100%, the Permittee shall contact the supplier to have this information provided); and E. The proposed method of application, application frequency, concentration, and daily average and maximum rates of use.</p> <p>Upon review of the information submitted regarding the proposed chemical additive, the MPCA may require additional information be submitted for consideration. This permit may be modified to restrict the use or discharge of a chemical additive and include additional influent and effluent monitoring requirements. Approval for the use of an additive shall not justify the exceedance of any effluent limitation nor shall it be used as a defense against pollutant levels in the discharge causing or contributing to the violation of a water quality standard. [Minn. R. 7001.0170]</p>
5.16.123	<p>MPCA Initiated Permit Modification, Suspension, or Revocation. The MPCA may modify or revoke and reissue this permit pursuant to Minn. R. 7001.0170. The MPCA may revoke without reissuance of this permit pursuant to Minn. R. 7001.0180. [Minn. R. 7001.0170, Minn. R. 7001.0180]</p>
5.16.124	<p>Total Maximum Daily Load (TMDL) Impacts. The MPCA may require facilities that discharge to an impaired surface water, watershed, or drainage basin to comply with additional permits or permit requirements. These requirements can include additional restriction or relaxation of limits and monitoring as authorized by the CWA 303(d)(4)(A) and 40 CFR ch. 122.44(l)(2)(i), necessary to ensure consistency with the assumptions and requirements of any applicable EPA approved wasteload allocations resulting from TMDL studies. [40 CFR 122.44(l)(2)j]</p>
5.16.125	<p>Permit Transfer. This permit is not transferable to any person without the express written approval of the MPCA after compliance with the requirements of Minn. R. 7001.0190. A person who receives permit transference shall comply with the conditions of this permit. [Minn. R. 7001.0150, subp. 3(N)]</p>

5.16.126		<p>Facility Closure. The Permittee is responsible for closure and post-closure care of the facility. The Permittee shall notify the MPCA of a significant reduction or cessation of the activities described in this permit at least 180 days before the reduction or cessation. The MPCA may require the Permittee to provide a Facility Closure Plan to the MPCA for approval.</p> <p>The MPCA may require a permit modification or reissuance for facility closure that could result in a potential long-term water quality concern, such as the ongoing discharge of wastewater to surface or groundwater.</p> <p>The MPCA may require the Permittee to establish and maintain financial assurance to ensure performance of certain obligations under this permit, including closure, post-closure care, and remedial action at the facility. If the MPCA requires financial assurance, the MPCA shall approve the amount and type of financial assurance, and proposed modifications to previously MPCA-approved financial assurance. [Minn. Stat. ch. 116.07, subd. 4]</p>
5.16.127		<p>Permit Reissuance. If the Permittee desires to continue permit coverage beyond the date of permit expiration, the Permittee shall submit an application for permit reissuance : Due by 180 days prior to permit expiration. [Minn. R. 7001.0040]</p>
5.16.128		<p>If the Permittee does not intend to continue the activities authorized by this permit after the expiration date of this permit, the Permittee shall notify the MPCA in writing at least 180 days before permit expiration. If the Permittee has submitted a timely application for permit reissuance, the Permittee may continue to conduct the activities authorized by this permit, in compliance with the requirements of this permit, until the MPCA takes final action on the application, unless the MPCA determines any of the following:</p> <ul style="list-style-type: none"> A. The Permittee is not in substantial compliance with the requirements of this permit, or with a stipulation agreement or compliance schedule designed to bring the Permittee into compliance with this permit; B. The MPCA, as a result of an action or failure to act by the Permittee, has been unable to take final action on the application on or before the expiration date of the permit; or C. The Permittee has submitted an application with major deficiencies or has failed to properly supplement the application in a timely manner after being informed of deficiencies. [Minn. R. 7001.0040, Minn. R. 7001.0160]
		<p>Facility Specific Requirements</p>
5.17.129		<p>The Permittee shall submit final construction plans and specification for the chosen alternative, for MPCA review and approval, 14 days prior to beginning construction. [Minn. R. 7001]</p>

6. Submittal action summary

GW 001	Piezometer, Other	
		Groundwater Well: Large Subsurface Sewage Treatment System Piezometer Monitoring Requirements
	6.1.1	The Permittee shall submit a monthly DMR : Due by 21 days after the end of each calendar month following permit issuance. [Minn. R. 7001.0150, Subp. 2(B)], Phases: Phase 1, Phase 2, Phase 3
WS 001	Influent Waste	
		Waste Stream: Large Subsurface Sewage Treatment System Influent Monitoring Requirements
	6.2.1	The Permittee shall submit a monthly DMR : Due by 21 days after the end of each calendar month following permit issuance. [Minn. R. 7001.0150, Subp. 2(B)], Phases: Phase 1, Phase 2, Phase 3
WS 002	Internal Waste Stream	
		Waste Stream: Drainfield Septic Tank Requirements
	6.3.1	The Permittee shall submit a monthly DMR : Due by 21 days after the end of each calendar month following permit issuance. [Minn. R. 7001.0150, Subp. 2(B)]
WS 003	Influent Waste	
		Waste Stream: Large Subsurface Sewage Treatment System Influent Monitoring Requirements
	6.4.1	The Permittee shall submit a monthly DMR : Due by 21 days after the end of each calendar month following permit issuance. [Minn. R. 7001.0150, Subp. 2(B)], Phases: Phase 1, Phase 2, Phase 3
WS 004	Internal Waste Stream	
		Waste Stream: Drainfield Septic Tank Requirements
	6.5.1	The Permittee shall submit a monthly DMR : Due by 21 days after the end of each calendar month following permit issuance. [Minn. R. 7001.0150, Subp. 2(B)]
WS 005	Influent Waste	
		Waste Stream: Large Subsurface Sewage Treatment System Influent Monitoring Requirements
	6.6.1	The Permittee shall submit a monthly DMR : Due by 21 days after the end of each calendar month following permit issuance. [Minn. R. 7001.0150, Subp. 2(B)], Phases: Phase 3
WS 006	Internal Waste Stream	
		Waste Stream: Drainfield Septic Tank Requirements

	6.7.1	The Permittee shall submit a monthly DMR : Due by 21 days after the end of each calendar month following permit issuance. [Minn. R. 7001.0150, Subp. 2(B)], Phases: Phase 3
WS 007	Influent Waste	
		Waste Stream: Large Subsurface Sewage Treatment System Influent Monitoring Requirements
	6.8.1	The Permittee shall submit a monthly DMR : Due by 21 days after the end of each calendar month following permit issuance. [Minn. R. 7001.0150, Subp. 2(B)], Phases: Phase 2, Phase 3
WS 008	Internal Waste Stream	
		Waste Stream: Drainfield Septic Tank Requirements
	6.9.1	The Permittee shall submit a monthly DMR : Due by 21 days after the end of each calendar month following permit issuance. [Minn. R. 7001.0150, Subp. 2(B)], Phases: Phase 2, Phase 3
MN0071501	YMCA of the Greater Twin Cities	
		Special Requirements
	6.10.1	The Permittee shall install influent flow equipment at both the 2 bedroom and 5 bedroom homes. The equipment shall be installed within 1 year of permit issuance. install equipment : Due by one year after permit issuance. [Minn. R. 7001]
	6.10.2	The Permittee shall notify the MPCA in writing within 30 days of installation of the influent flow equipment at the 2 bedroom and 5 bedroom homes. notify MPCA : Due within 30 days. [Minn. R. 7001]
	6.10.3	The Permittee shall install a piezometer to measure depth to groundwater within the 5 bedroom home drainfield. The piezometer shall be installed within 1 year of permit issuance. install : Due by one year after permit issuance. [Minn. R. 7001]
	6.10.4	The Permittee shall notify MPCA in writing within 30 days of the installation of the piezometer within the 5 bedroom home drainfield system. notify MPCA : Due within 30 days. [Minn. R. 7001]
	6.10.5	The Permittee shall submit an annual report 1 year after permit issuance. The report shall include but not be limited to: <ul style="list-style-type: none"> a) a discussion for the past year's flow monitoring, b) a discussion on whether the flow data indicates a need for the construction of a 2nd mound, c) if additional capacity is needed, then the permittee shall submit an application for a permit modification, d) the permit modification should include a soils and groundwater evaluation, e) the evaluation of the groundwater should propose the number and locations of ground water monitoring wells, f) this report would be the trigger to start the construction of the 2nd mound system. submit an annual report : Due by one year after permit issuance. [Minn. R. 7001]

		Large Subsurface Treatment System (LSTS)
	6.11.6	The Permittee shall submit a copy of the certification card : Due by 2.5 years after permit issuance The copy of the Service Provider's Subsurface Sewage Treatment System (SSTS) Individual Certification Card shall display the Certification Number and be sent to the MPCA, Attn: WQ Submittals Center. [Minn. R. 7001.0150, Subp. 3(F)]
		Total Facility Requirements (SDS)
	6.12.7	Permit Reissuance. If the Permittee desires to continue permit coverage beyond the date of permit expiration, the Permittee shall submit an application for permit reissuance : Due by 180 days prior to permit expiration. [Minn. R. 7001.0040]

DRAFT

7. Limits and monitoring

Subject item	Parameter	Discharge limitations						Monitoring requirements				Notes
		Quantity /Loading avg.	Quantity /Loading max.	Quantity /Loading units	Quality /Conc. min.	Quality /Conc. avg.	Quality /Conc. max.	Quality/ Conc. units	Frequency	Sample type	Effective period	
GW 001 Piezometer - 5 Bedroom House Phase 1	Separation to Ground Water		Monitor only. instantaneous maximum	inches					once per month	Measurement	Jul	
GW 001 Piezometer - 5 Bedroom House Phase 2	Separation to Ground Water		Monitor only. instantaneous maximum	inches					once per month	Measurement	Jul	
GW 001 Piezometer - 5 Bedroom House Phase 3	Separation to Ground Water		Monitor only. instantaneous maximum	inches					once per month	Measurement	Jul	
WS 001 Influent Waste - 2 Bedroom House Phase 1	Flow		Monitor only. calendar month total	million gallons		Monitor only. calendar month average	Monitor only. daily maximum	million gallons per day	once per month	Measurement, Continuous	May-Oct	
WS 001 Influent Waste - 2 Bedroom House Phase 2	Flow		Monitor only. calendar month total	million gallons		Monitor only. calendar month average	Monitor only. daily maximum	million gallons per day	once per month	Measurement, Continuous	May-Oct	
WS 001 Influent Waste - 2 Bedroom House Phase 3	Flow		Monitor only. calendar month total	million gallons		Monitor only. calendar month average	Monitor only. daily maximum	million gallons per day	once per month	Measurement, Continuous	May-Oct	
WS 002 Septic Tank - 2 Bedroom House	Remaining Scum Capacity		Monitor only. calendar month maximum	inches					once per month	Measurement	Oct	
WS 002 Septic Tank - 2 Bedroom House	Remaining Sludge Capacity		Monitor only. calendar month maximum	inches					once per month	Measurement	Oct	
WS 002 Septic Tank - 2 Bedroom House	Scum Depth, Maximum of Sample		Monitor only. calendar month maximum	inches					once per month	Measurement	Oct	
WS 002 Septic Tank - 2 Bedroom House	Sludge Depth, Maximum of Sample		Monitor only. calendar month maximum	inches					once per month	Measurement	Oct	

Subject item	Parameter	Discharge limitations					Monitoring requirements					Notes
		Quantity /Loading avg.	Quantity /Loading max.	Quantity /Loading units	Quality /Conc. min.	Quality /Conc. avg.	Quality /Conc. max.	Quality/ Conc. units	Frequency	Sample type	Effective period	
WS 003 Influent Waste - 5 Bedroom House Phase 1	Flow		Monitor only. calendar month total	million gallons		Monitor only. calendar month average	Monitor only. daily maximum	million gallons per day	once per month	Measurement, Continuous	May-Oct	
WS 003 Influent Waste - 5 Bedroom House Phase 2	Flow		Monitor only. calendar month total	million gallons		Monitor only. calendar month average	Monitor only. daily maximum	million gallons per day	once per month	Measurement, Continuous	May-Oct	
WS 003 Influent Waste - 5 Bedroom House Phase 3	Flow		Monitor only. calendar month total	million gallons		Monitor only. calendar month average	Monitor only. daily maximum	million gallons per day	once per month	Measurement, Continuous	May-Oct	
WS 004 Septic Tank - 5 Bedroom House	Remaining Scum Capacity		Monitor only. calendar month maximum	inches					once per month	Measurement	Oct	
WS 004 Septic Tank - 5 Bedroom House	Remaining Sludge Capacity		Monitor only. calendar month maximum	inches					once per month	Measurement	Oct	
WS 004 Septic Tank - 5 Bedroom House	Scum Depth, Maximum of Sample		Monitor only. calendar month maximum	inches					once per month	Measurement	Oct	
WS 004 Septic Tank - 5 Bedroom House	Sludge Depth, Maximum of Sample		Monitor only. calendar month maximum	inches					once per month	Measurement	Oct	
WS 005 Influent Waste - Horse Barn Phase 3	Flow		Monitor only. calendar month total	million gallons		Monitor only. calendar month average	Monitor only. daily maximum	million gallons per day	once per month	Measurement, Continuous	May-Oct	
WS 006 Septic Tank - Horse Barn Phase 3	Remaining Scum Capacity		Monitor only. calendar month maximum	inches					once per month	Measurement	Oct	
WS 006 Septic Tank - Horse Barn Phase 3	Remaining Sludge Capacity		Monitor only. calendar month maximum	inches					once per month	Measurement	Oct	
WS 006 Septic Tank - Horse Barn Phase 3	Scum Depth, Maximum of Sample		Monitor only. calendar month maximum	inches					once per month	Measurement	Oct	

Subject item	Parameter	Discharge limitations					Monitoring requirements					Notes
		Quantity /Loading avg.	Quantity /Loading max.	Quantity /Loading units	Quality /Conc. min.	Quality /Conc. avg.	Quality /Conc. max.	Quality/ Conc. units	Frequency	Sample type	Effective period	
WS 006 Septic Tank - Horse Barn Phase 3	Sludge Depth, Maximum of Sample		Monitor only. calendar month maximum	inches					once per month	Measurement	Oct	
WS 007 Influent Waste - Pool System Phase 2	Flow		Monitor only. calendar month total	million gallons		Monitor only. calendar month average	Monitor only. daily maximum	million gallons per day	once per month	Measurement, Continuous	May-Oct	
WS 007 Influent Waste - Pool System Phase 3	Flow		Monitor only. calendar month total	million gallons		Monitor only. calendar month average	Monitor only. daily maximum	million gallons per day	once per month	Measurement, Continuous	May-Oct	
WS 008 Septic Tank #6- Pool System Phase 2	Remaining Scum Capacity		Monitor only. calendar month maximum	inches					once per month	Measurement	Oct	
WS 008 Septic Tank #6- Pool System Phase 3	Remaining Scum Capacity		Monitor only. calendar month maximum	inches					once per month	Measurement	Oct	
WS 008 Septic Tank #6- Pool System Phase 2	Remaining Sludge Capacity		Monitor only. calendar month maximum	inches					once per month	Measurement	Oct	
WS 008 Septic Tank #6- Pool System Phase 3	Remaining Sludge Capacity		Monitor only. calendar month maximum	inches					once per month	Measurement	Oct	
WS 008 Septic Tank #6- Pool System Phase 2	Scum Depth, Maximum of Sample		Monitor only. calendar month maximum	inches					once per month	Measurement	Oct	
WS 008 Septic Tank #6- Pool System Phase 3	Scum Depth, Maximum of Sample		Monitor only. calendar month maximum	inches					once per month	Measurement	Oct	
WS 008 Septic Tank #6- Pool System Phase 2	Sludge Depth, Maximum of Sample		Monitor only. calendar month maximum	inches					once per month	Measurement	Oct	
WS 008 Septic Tank #6- Pool System Phase 3	Sludge Depth, Maximum of Sample		Monitor only. calendar month maximum	inches					once per month	Measurement	Oct	